

# WTCA STANDARD DETAILS

## Gable End Bracing

Figure 16.8.23 WTCA standard industry detail for gable end bracing. Available for free download at [www.woodtruss.com](http://www.woodtruss.com).

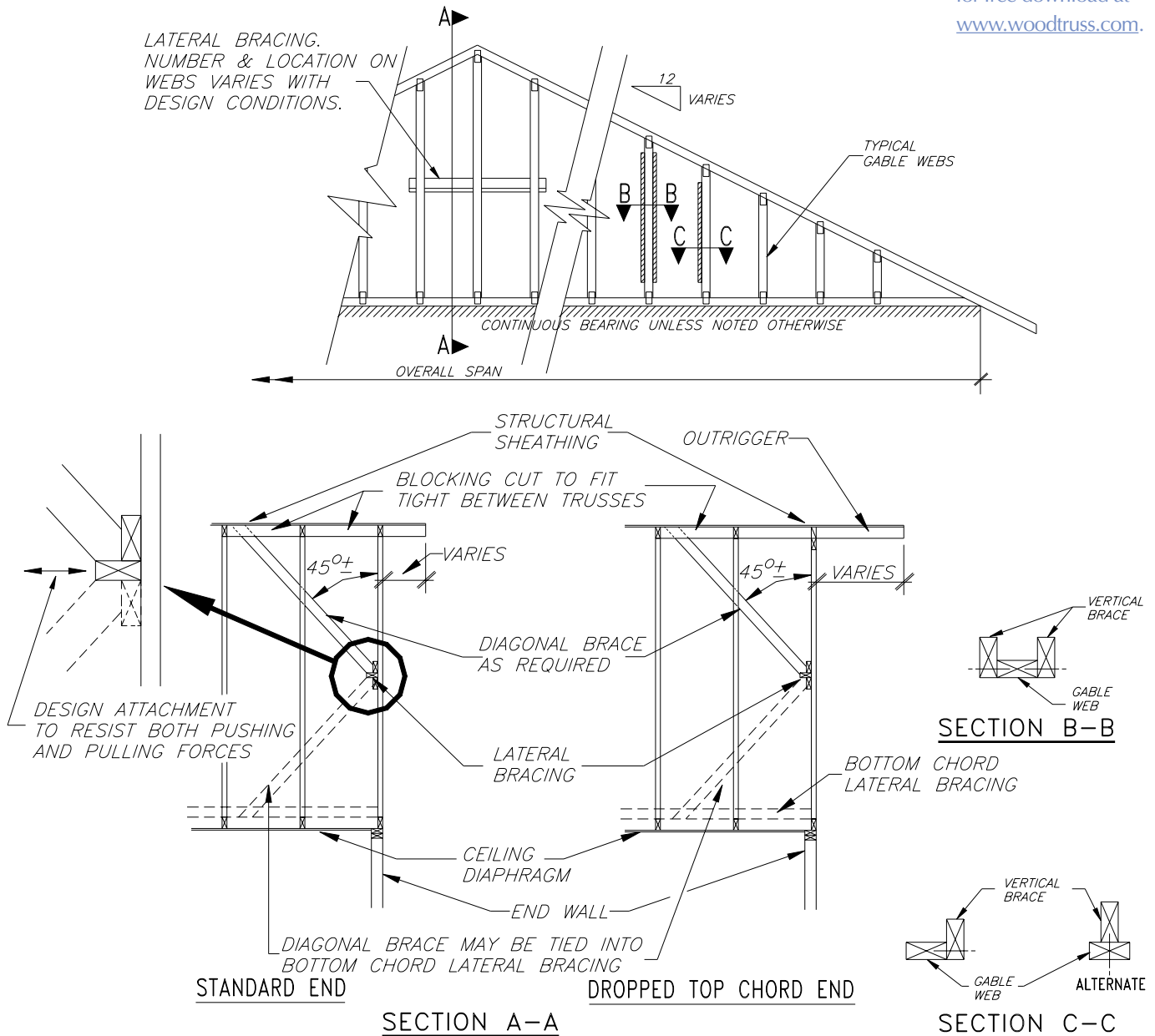

### NOTES:

- 1) ACTUAL BRACING REQUIREMENTS WILL VARY DUE TO WIND LOAD, CODE CRITERIA, BUILDING HEIGHT, TRUSS SPAN, WEB LUMBER GRADE/SPECIES/ON CENTER SPACING AND OTHER VARIABLES. BRACING (AND ATTACHMENT) REQUIREMENTS SHOULD BE DESIGNED FOR EACH SPECIFIC JOB.
- 2) CONNECTION BETWEEN BOTTOM CHORD OF GABLE END TRUSS AND WALL, AS WELL AS THE DESIGN AND SPECIFICATION OF TEMPORARY AND PERMANENT BRACING OF THE ROOF SYSTEM IS THE RESPONSIBILITY OF THE BUILDING DESIGNER.

Figure 16.8.23

# WTCA STANDARD DETAILS Blocking at Wall Type "A"

Figure 16.8.24 WTCA standard industry detail: Blocking at Wall Type "A". Available for free download at [www.woodtruss.com](http://www.woodtruss.com).

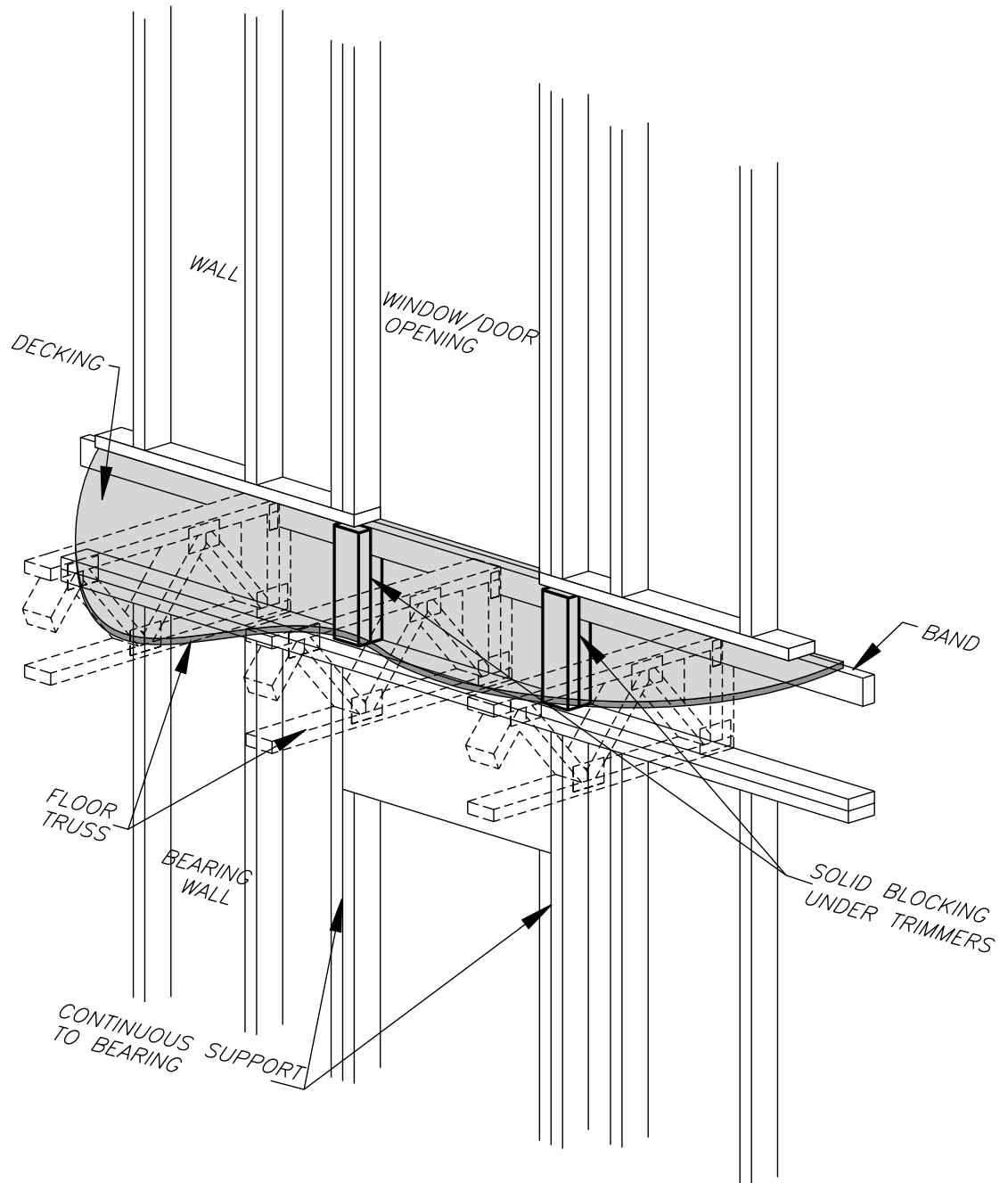

BLOCKING IN FLOOR SPACE @  
END BEARING TRUSS w/ BAND

Figure 16.8.24

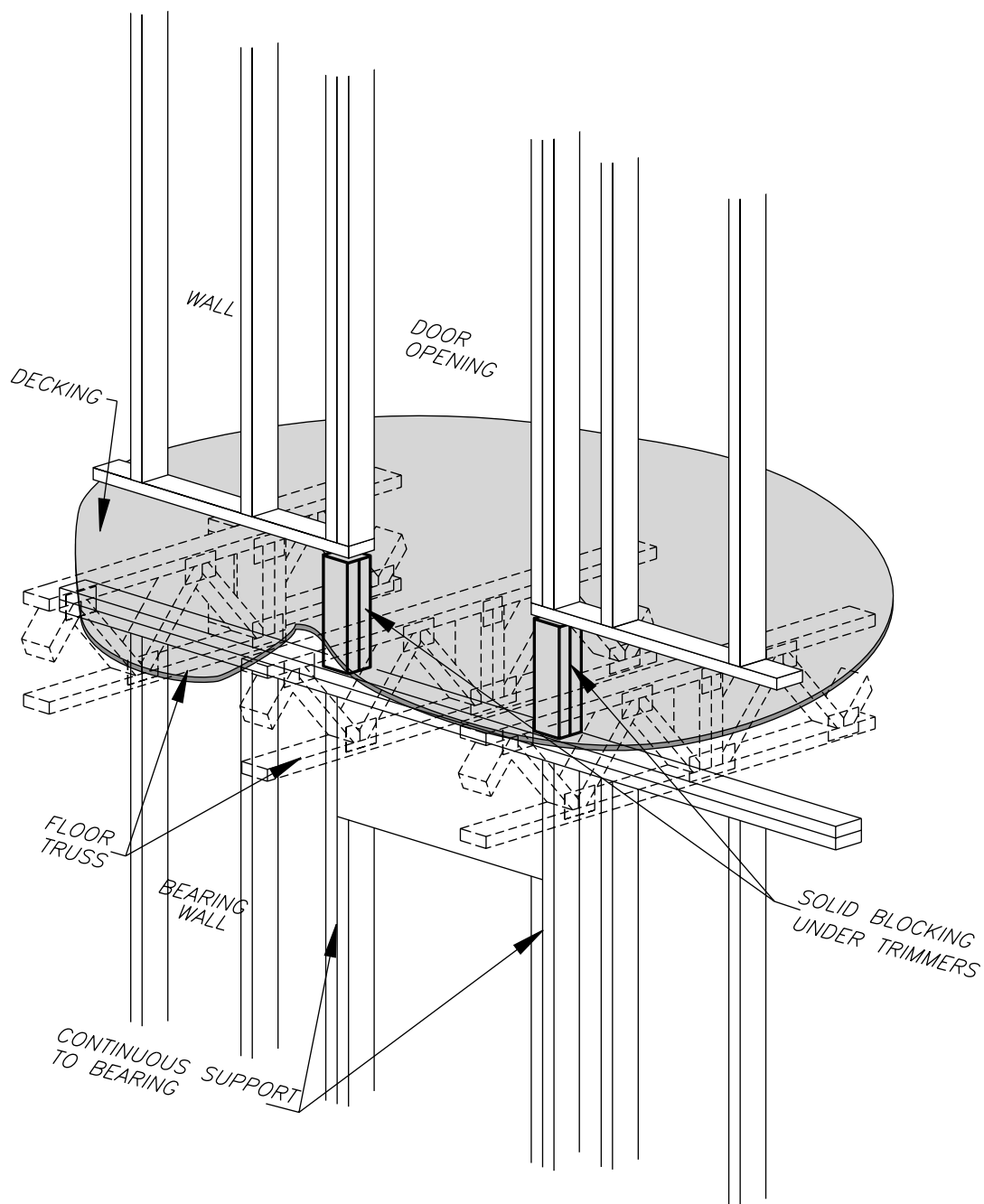

Figure 16.8.25 WTCA  
standard industry  
detail: Blocking at Wall  
Type "B". Available  
for free download at  
[www.woodtruss.com](http://www.woodtruss.com).

## BLOCKING IN FLOOR SPACE @ INTERIOR BEARING CONDITION

Figure 16.8.25

## WTCA STANDARD DETAILS

### Blocking at Wall Type "C"

Figure 16.8.26 WTCA standard industry detail: Blocking at Wall Type "C". Available for free download at [www.woodtruss.com](http://www.woodtruss.com).

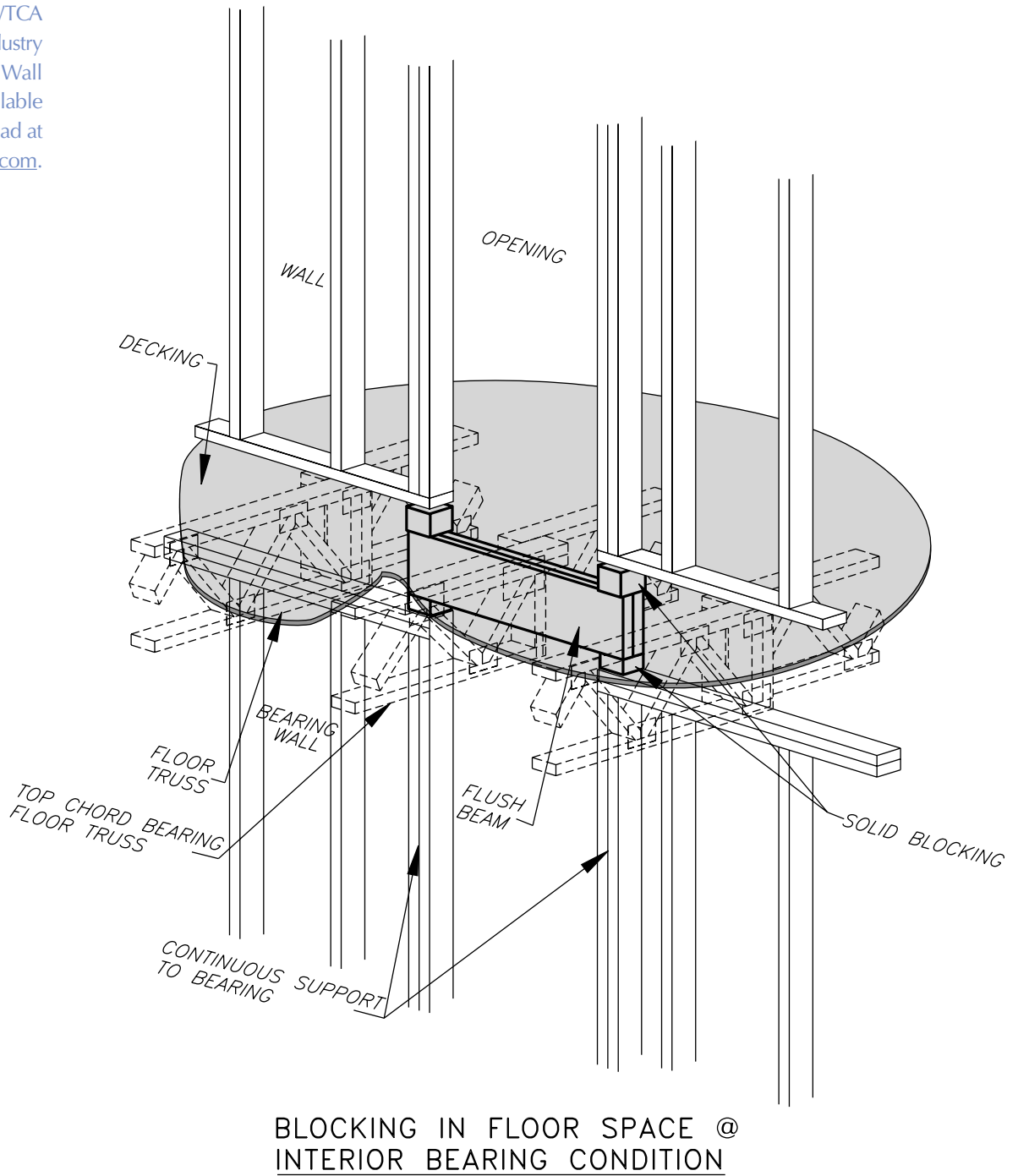
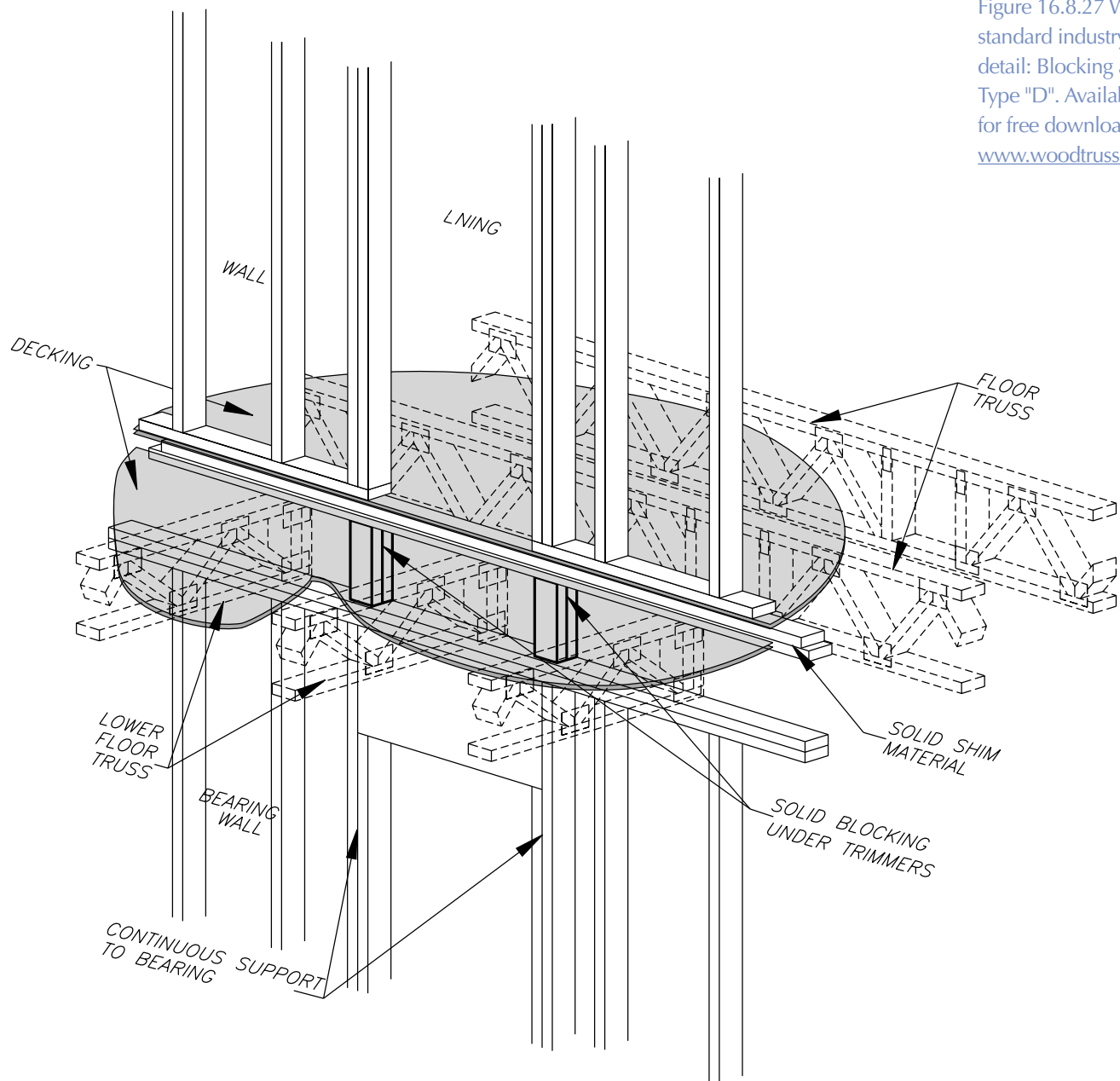

Figure 16.8.26

## WTCA STANDARD DETAILS

### Blocking at Wall Type "D"

Figure 16.8.27 WTCA standard industry detail: Blocking at Wall Type "D". Available for free download at [www.woodtruss.com](http://www.woodtruss.com).



### BLOCKING IN FLOOR SPACE @ FLOOR ELEVATION CHANGE

Figure 16.8.27

# WTCA STANDARD DETAILS Blocking at Wall Type "E"

Figure 16.8.28 WTCA standard industry detail: Blocking at Wall Type "E". Available for free download at [www.woodtruss.com](http://www.woodtruss.com).

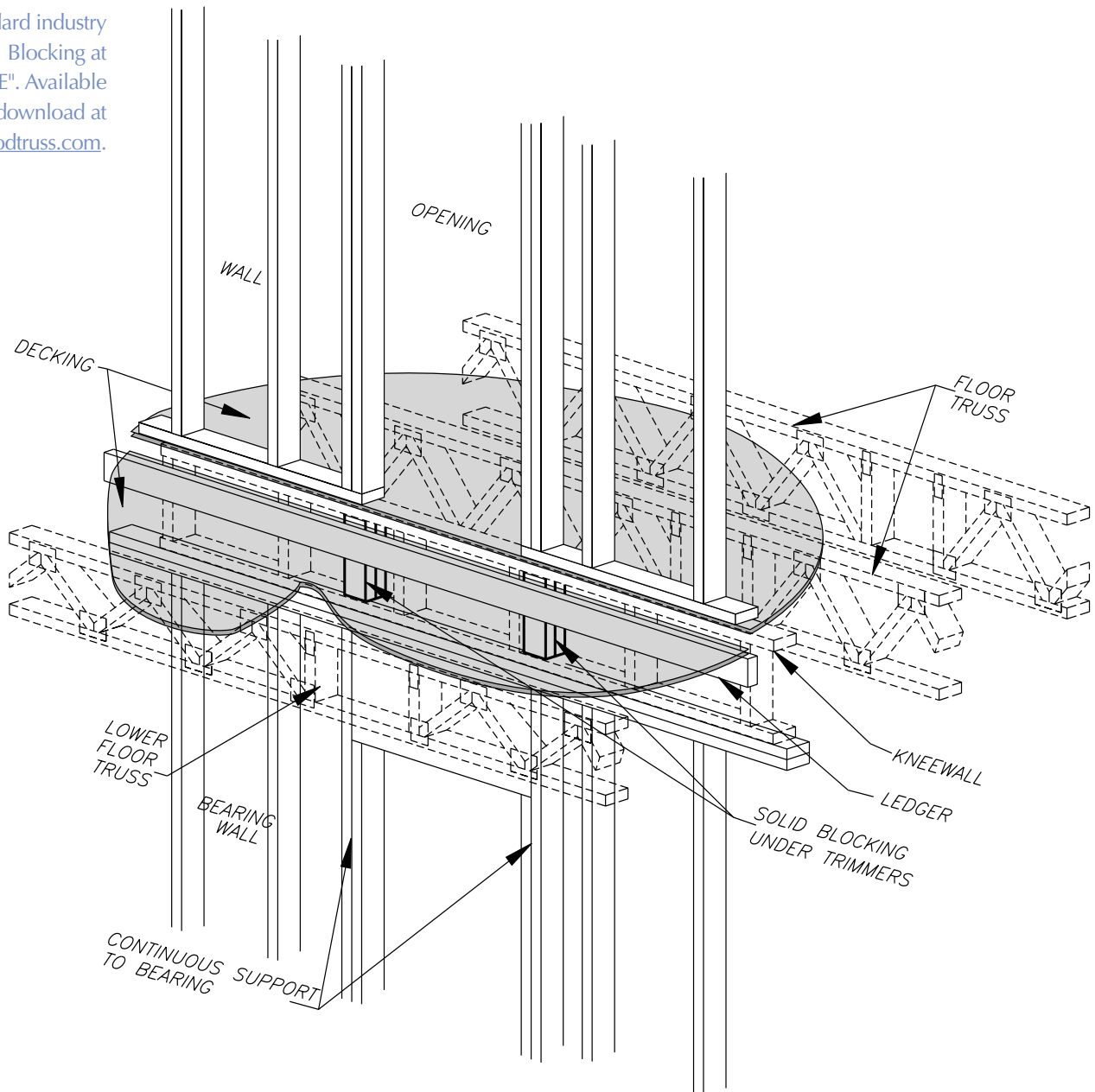

**BLOCKING IN FLOOR SPACE @  
FLOOR ELEVATION CHANGE**

Figure 16.8.28

# WTCA STANDARD DETAILS

## Roof

Figure 16.8.29 WTCA standard industry details: Roof. Available for free download at [www.woodtruss.com](http://www.woodtruss.com).

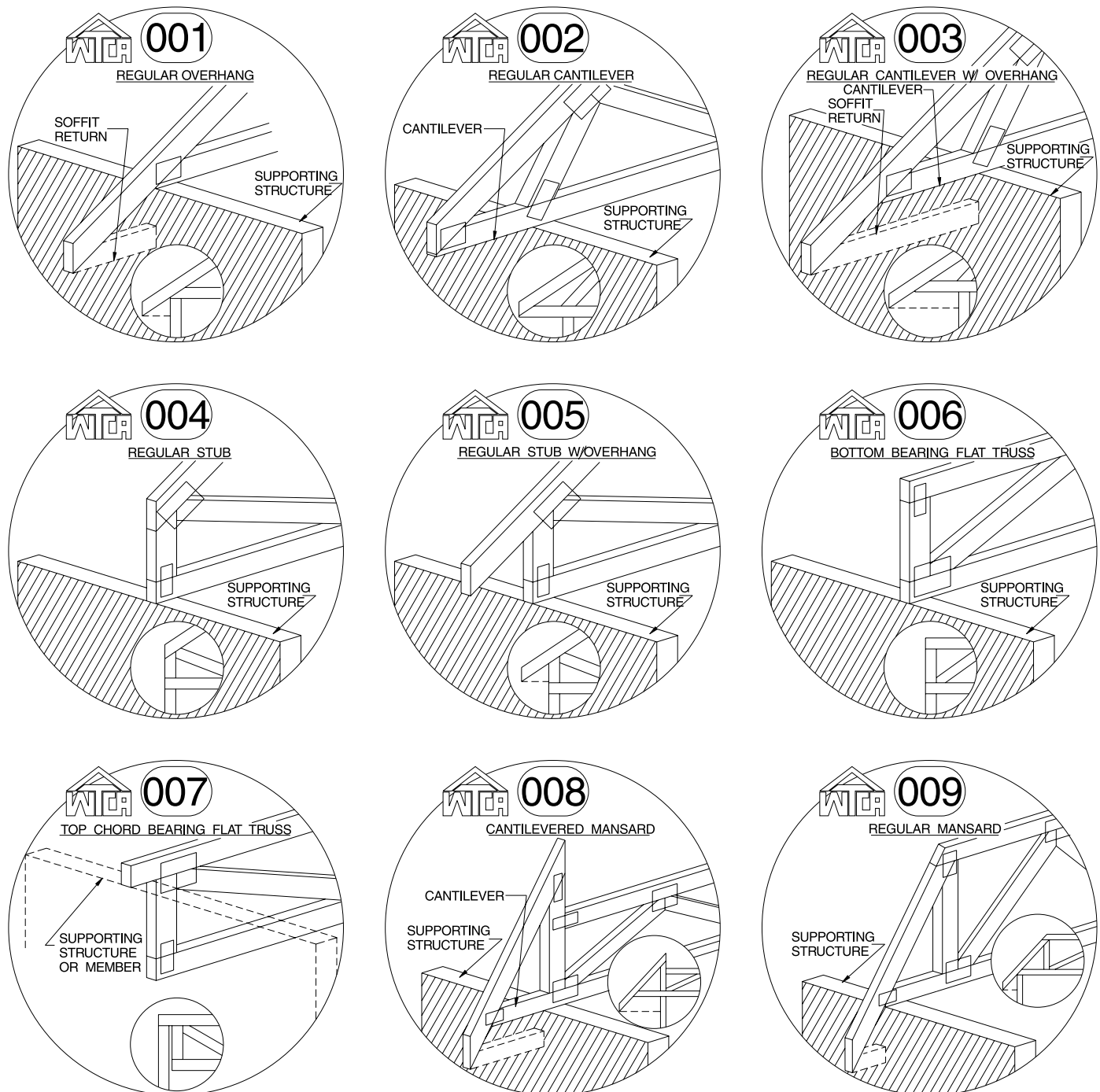
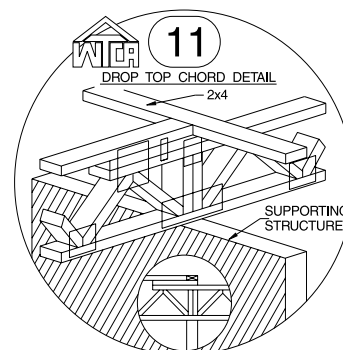
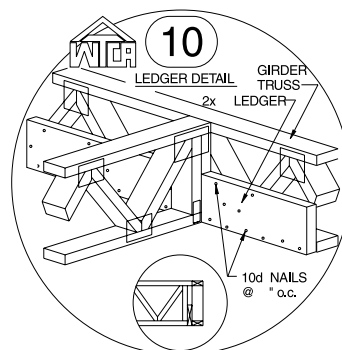
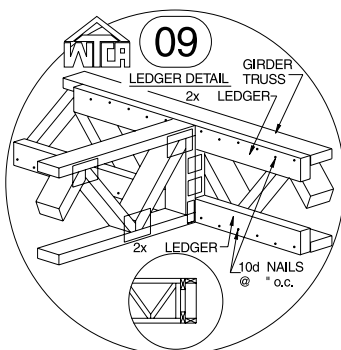
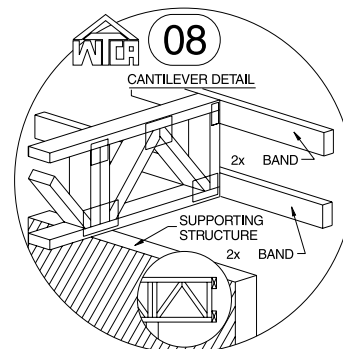
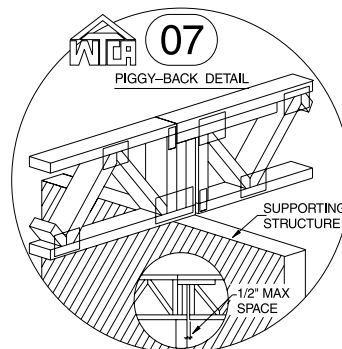
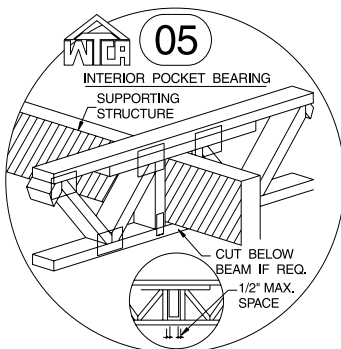
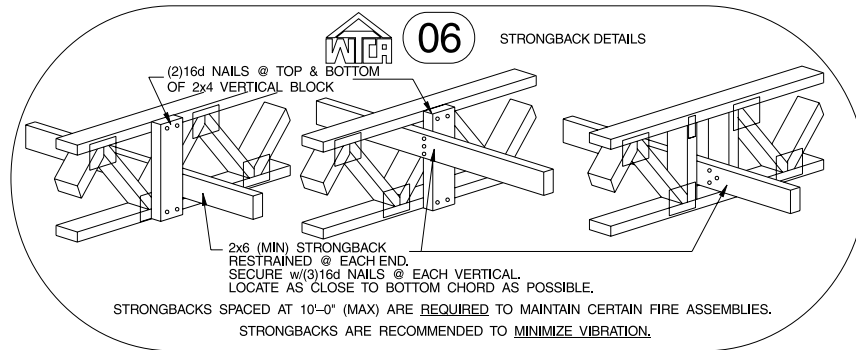
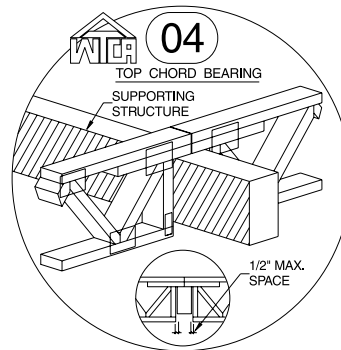
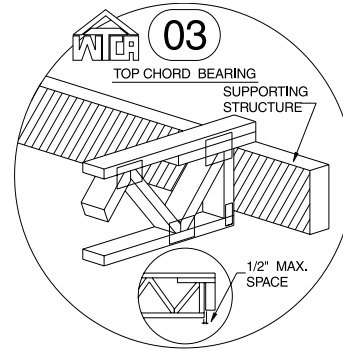
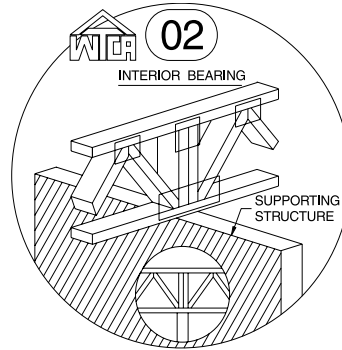
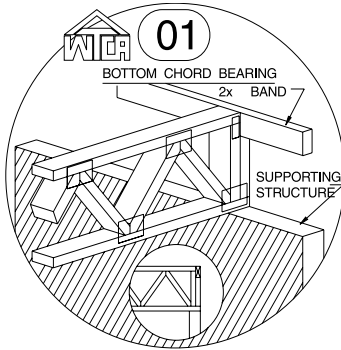

Figure 16.8.29

# WTCA STANDARD DETAILS Floor





# WTCA STANDARD DETAILS Floor

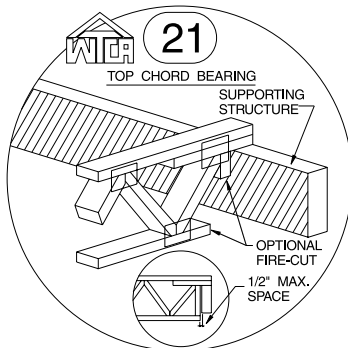
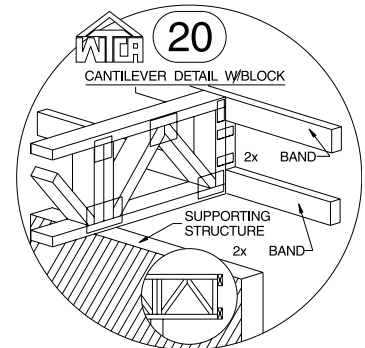
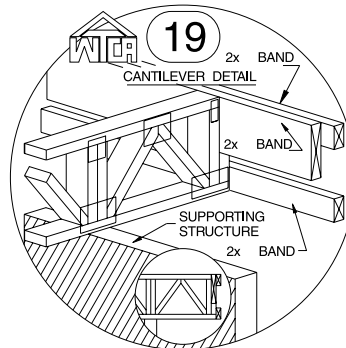
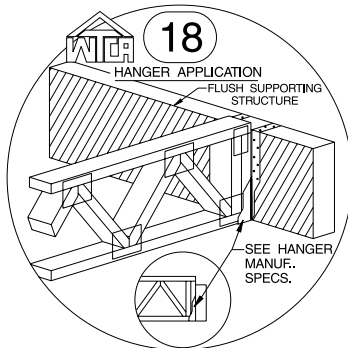
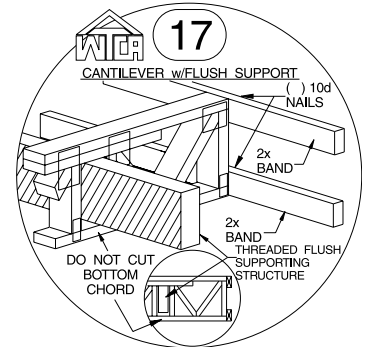
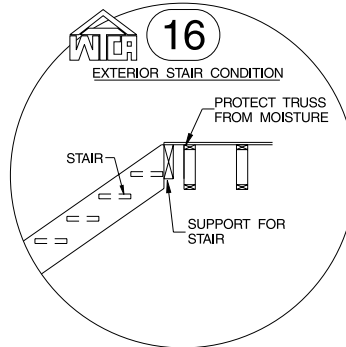
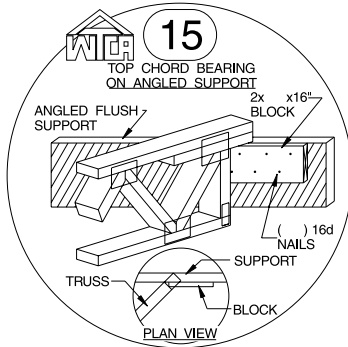
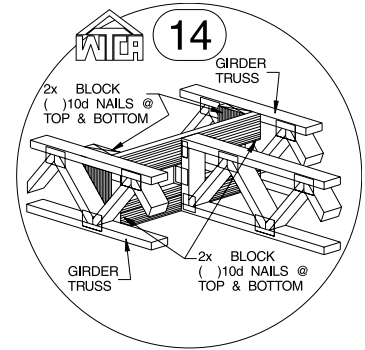
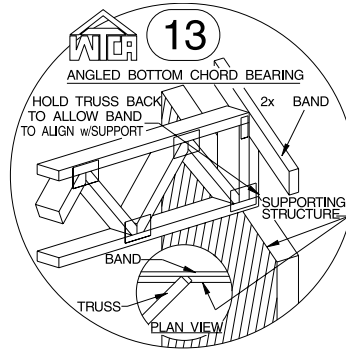
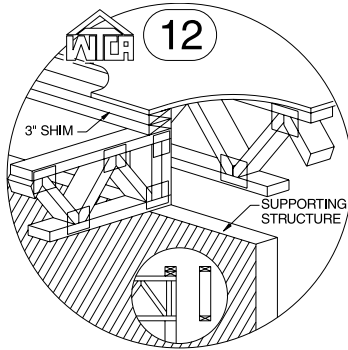

## WTCA STANDARD DETAILS

### Hanger Hardware

Figure 16.8.33 WTCA standard industry details: Hanger Hardware. Available for free download at [www.woodtruss.com](http://www.woodtruss.com).

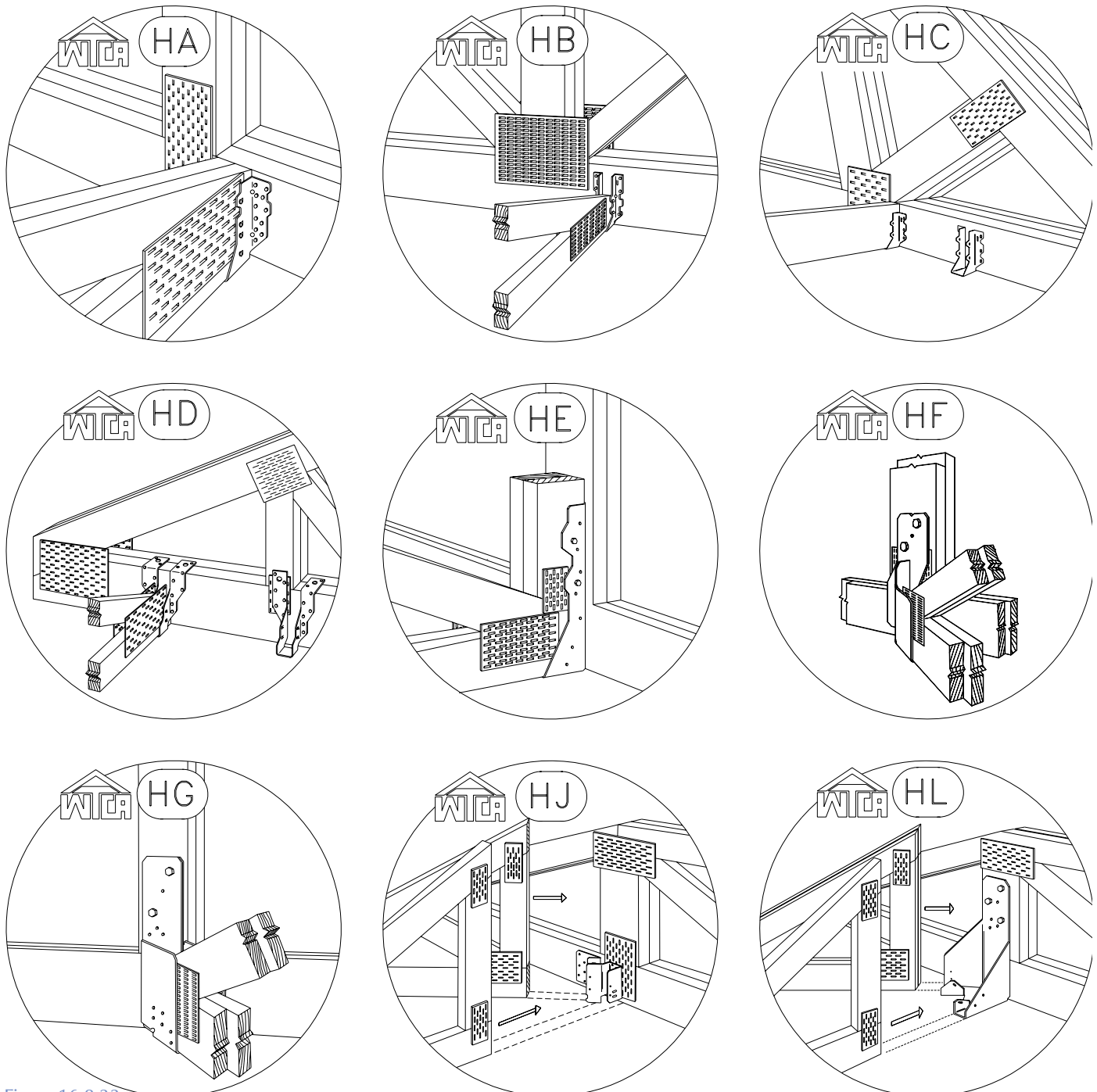

Figure 16.8.33

## WTCA STANDARD DETAILS

### Hanger Hardware (cont.)

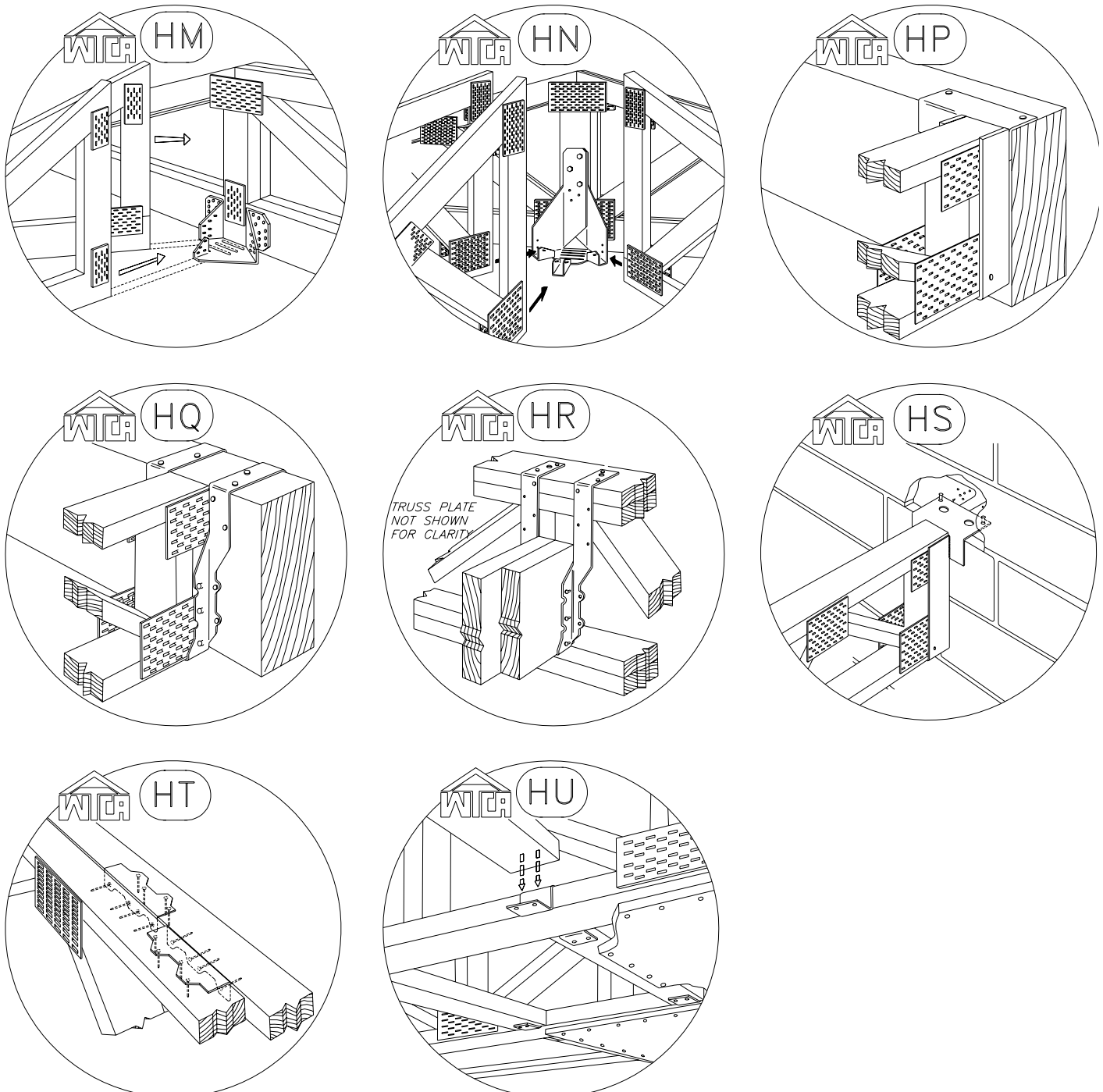

Figure 16.8.33 (cont.)

# WTCA STANDARD DETAILS

## Masonry Hold-Down Hardware

Figure 16.8.34 WTCA standard industry details: Masonry Hold-Down Hardware. Available for free download at [www.woodtruss.com](http://www.woodtruss.com).

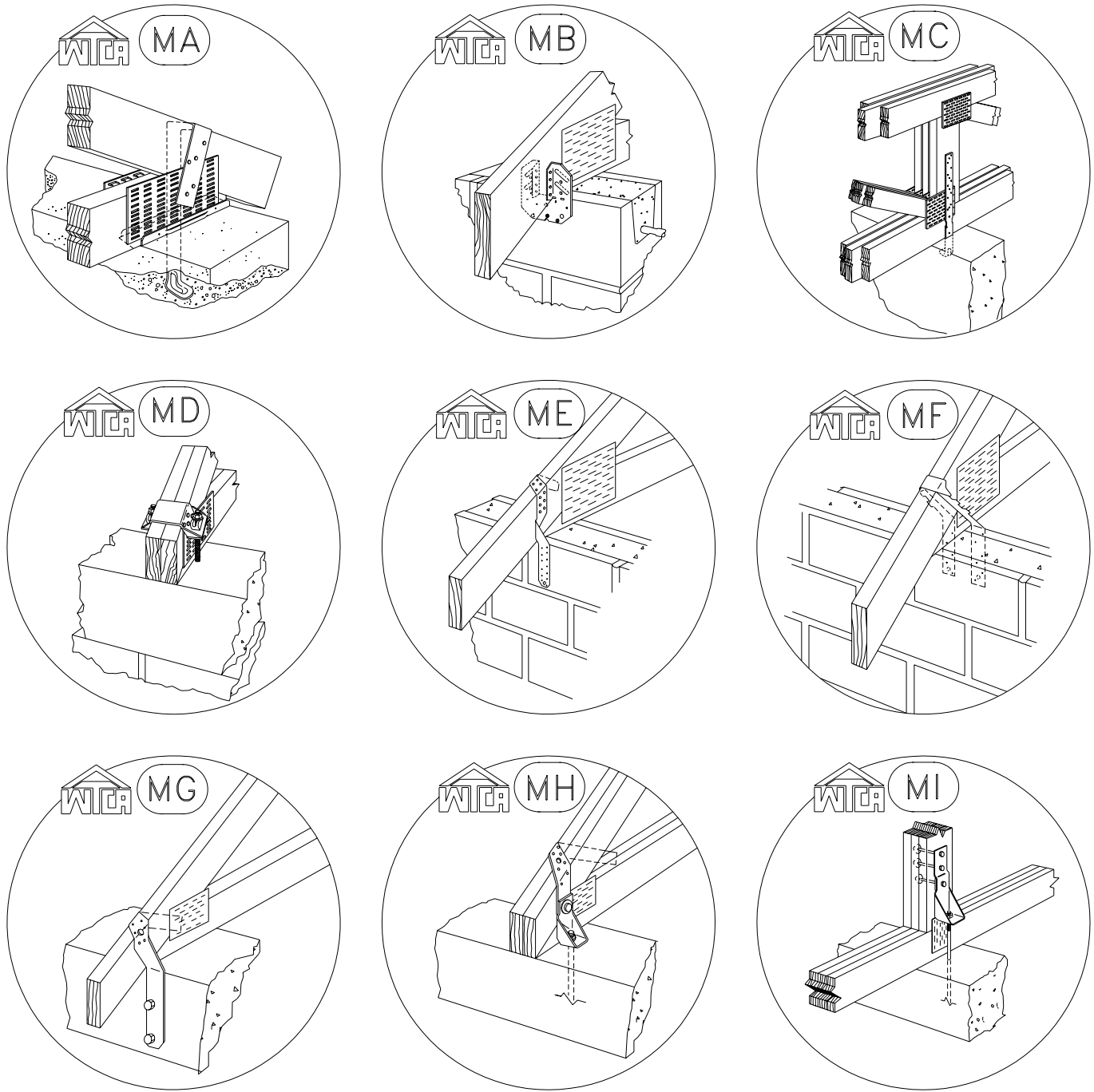
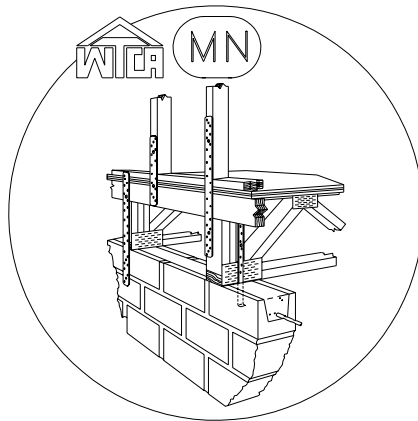
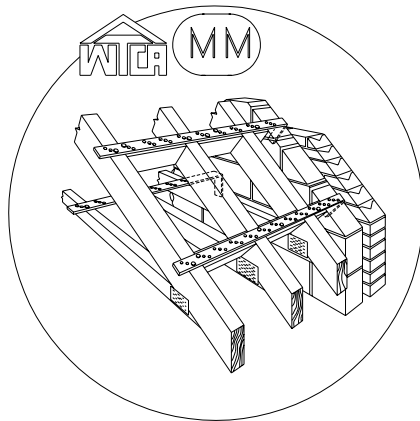
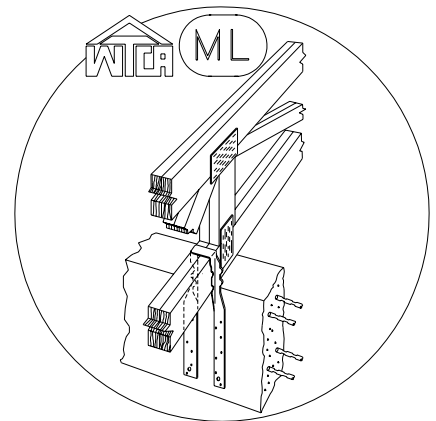
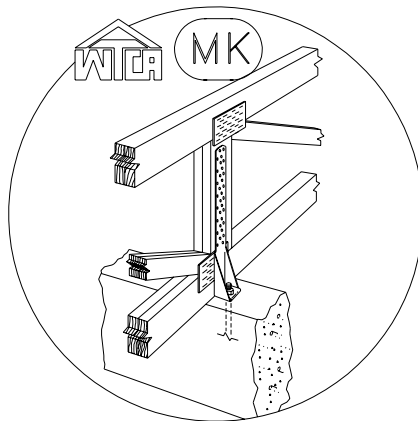
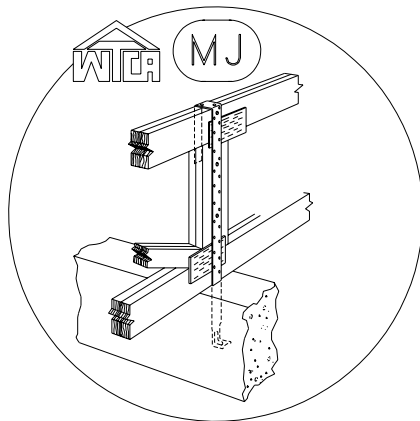

Figure 16.8.34

## WTCA STANDARD DETAILS

### Masonry Hold-Down Hardware (cont.)



# WTCA STANDARD DETAILS Wood Hold-Down Hardware

Figure 16.8.36 WTCA standard industry details: Wood Hold-Down Hardware. Available for free download at [www.woodtruss.com](http://www.woodtruss.com).

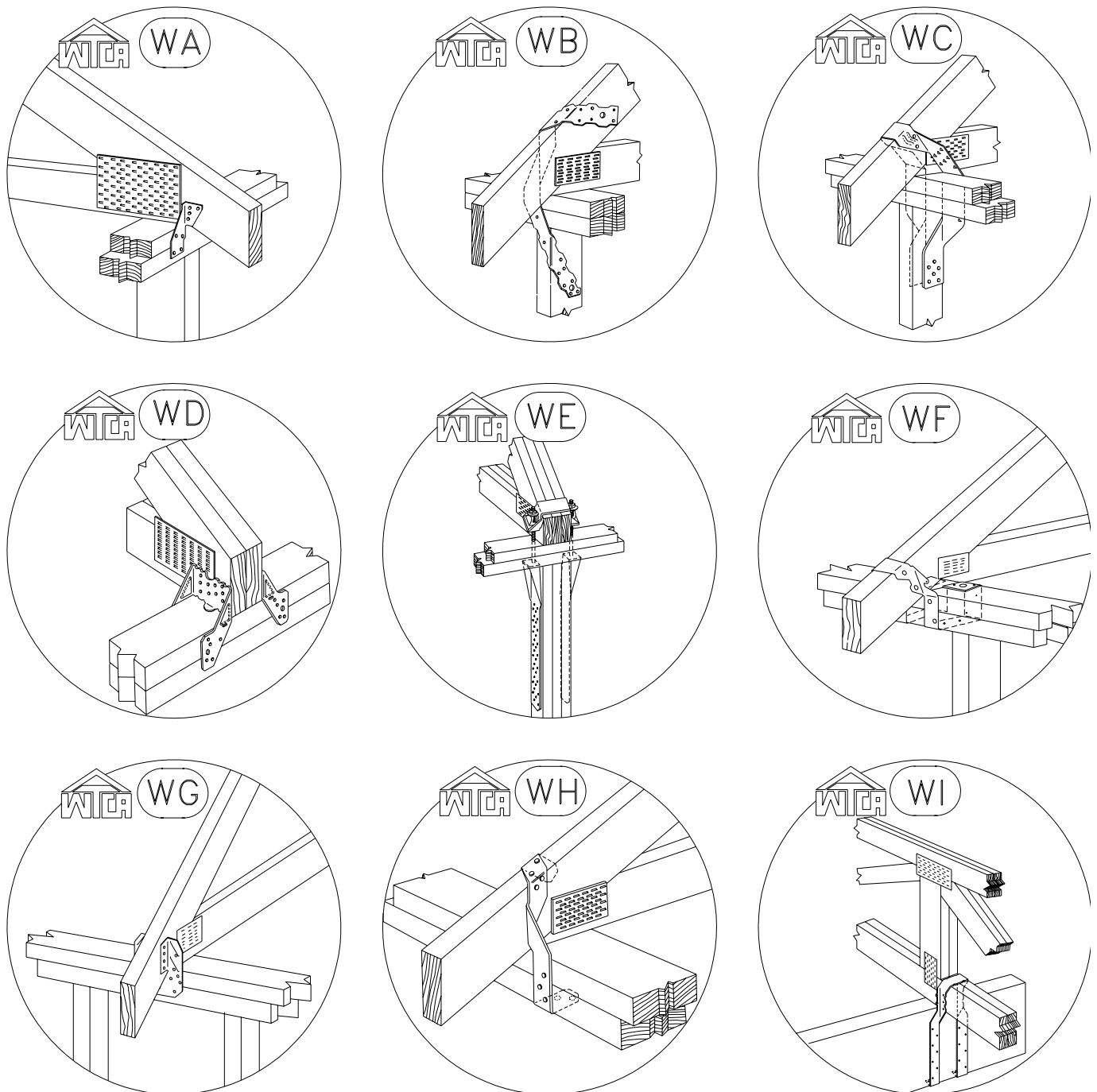

Figure 16.8.36

## WTCA STANDARD DETAILS

### Wood Hold-Down Hardware (cont.)

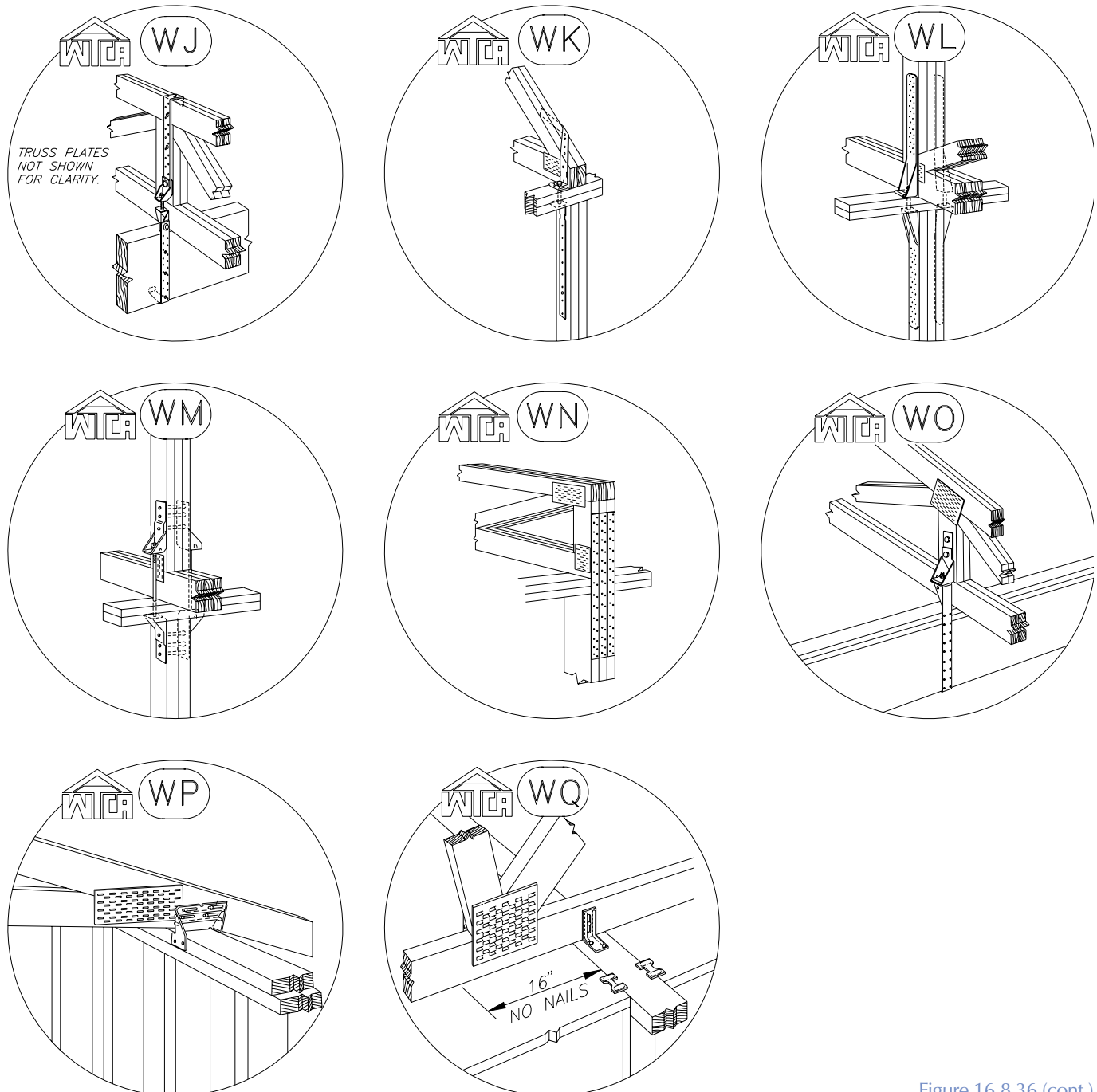

Figure 16.8.36 (cont.)